

B.Sc.T.Y

M.S.P.Mandals
Chhatrapati Shahu Art's Commerce & Science College Lasur Station
Dept Of Art'/Commerce/Science/BCA

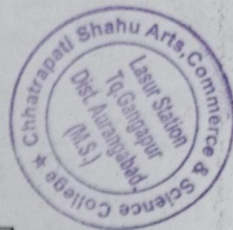

Subject :- Physics (III.TY) - 305 Date:- 04/01/2020

Sr.No	Name Of Student	Marks	Sign
1	Damale Priya Mohan	10	<i>[Signature]</i>
2	Kale piyanka kakasabeb	7	<i>[Signature]</i>
3	Jarwal Aarti Bhagatsing	8	<i>[Signature]</i>
4	Ghodke Vishwanath Ramnaisan	00	<i>[Signature]</i>
5			
6			
7			
8			
9			
10			
11			
12			
13			
14			
15			
16			
17			
18			
19			
20			
21			
22			
23			
24			
25			

[Signature]
Co-ordinator
I.Q.A.C.
Chhatrapati Shahu Arts, Com & Sci. College
Lasur Station Tq. Gangapur

[Signature]
Principal
Chhatrapati Shahu Arts,
Commerce & Science Colleg
Lasur Station Tq. Gangapur
Dist. Aurangabad. (M.S.)

EXPERIMENT :

No.

Vvrit test - II

Page No.
Date

Q 1. Multiple choice Questions (5)

1) The size of the atom is nearly equal to

- a) 1nm
- b) 1 micron
- c) 1 A°
- d) 1 fermi

2) The empirical atomic model was given by

- a) J.J. Thomson
- b) E. Rutherford
- c) Niels Bohr
- d) Sommerfield

3) The nuclear model of atom was proposed by

- a) J.J. Thomson
- b) Rutherford
- c) Niels Bohr
- d) Sommerfield

4) Electrons in the atom are held due to

- a) Coulomb force
- b) Nuclear force
- c) gravitational force
- d) vanden waal's force

Q 2. Attempt any three questions (15)

1) Explain Rutherford's atom model. what are the drawbacks of this model? (5)

2) Explain Bohr's postulates for the Theory of hydrogen atom. (5)

B.Sc. F.Y

M.S.P.Mandals
Chhatrapati Shahu Art's Commerce & Science College Lasur Station
Dept Of Art'/Commerce/Science/BCA

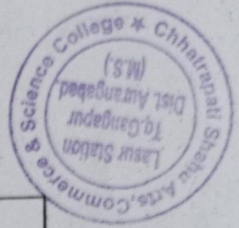

Subject :- physics

Date:- 06/01/2020

Sr.No	Name Of Student	Marks	Sign
1	Gayatri Asey mahade	19	
2	Arhi koushree pawar	04	
3	Sansirani Pandit chavhan	11	
4			
5			
6			
7			
8			
9			
10			
11			
12			
13			
14			
15			
16			
17			
18			
19			
20			
21			
22			
23			
24			
25			

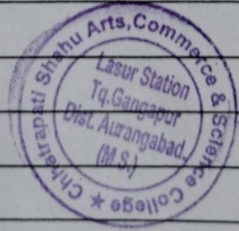

Co-ordinator
I.Q.A.C.

Principal
Chhatrapati Shahu Arts,
Commerce & Science College
Lasur Station Tq. Gangapur
Dist. Aurangabad. (M.S.)

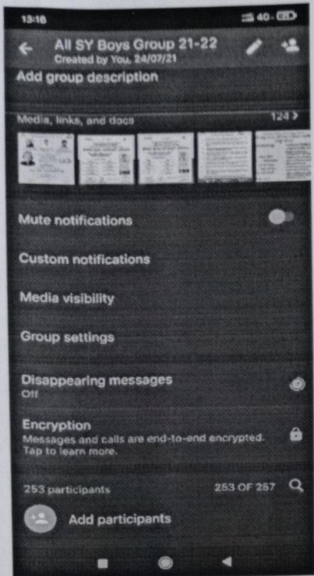

(Handwritten signature)

**Co-ordinator
I.Q.A.C.**

**Chatrapati Shahu Arts, Com & Sci. College
Lasur Station Tq Gangapur**

(Handwritten signature)
Principal

**Chhatrapati Shahu Arts
Commerce & Science Co.
Lasur Station Tq. Gangapur
Dist. Aurangabad. (M.S.)**